

UTICA CUTLERY CO[®]

2025

KUTMASTER 400 LINE



TABLE OF CONTENTS

PAGE	CATEGORY
3-5	USA Made Everyday Carry
6	USA Made Fillet Knives
7	USA Made Classic Lockbacks
8-9	USA Made Multi-Tools
10-11	USA Made Commemorative Knives
12-14	Cutlery
15	BBQ Multi Tool
16	Ceramic Knives
17	Steak Knives
18-20	Assorted Specialty Cutlery
21	Specialty Kitchen Accessories, Carving Set
22	Wine Openers
23	Fold A Spork
24-27	Produce Knives
28	Rescue Knife
29	Hunting Knife
30-31	Specialty Tools
32	Classic Folders
33	Mini Tools
34-35	Everyday Carry
36	Open Assist
37	Fillet Knife
38-39	General Information



15-2150E
USA Made Avocado Tool
Pg. 24



95-UB264L
BBQ Multi Tool
Pg 15



BALL BEARING ASSISTED OPENING

15-UTKE30E

- Liner Lock
- D2 Steel Blade
- Blade Length 2.25"
- Closed Length 3.13"
- Pocket Clip

Pricing includes electro etch on blade.

12	25	50	100	200	500
67.30	65.08	63.34	61.59	59.85	58.11
Set up - \$86.25G)			Imprint Area - 1-1/2" x 1/2"		
Shipping Weight - 12 pcs @ 3 lbs			Class - 6C		

NEW



BALL BEARING ASSISTED OPENING

15-UTKE37E

- Liner Lock
- D2 Steel Blade
- Blade Length 3"
- Closed Length 3.75"
- Pocket Clip

Pricing includes electro etch on blade.

12	25	50	100	200	500
67.57	65.61	63.85	62.09	60.33	58.58
Set up - \$86.25G)			Imprint Area - 1-1/2" x 1/2"		
Shipping Weight - 12 pcs @ 3 lbs			Class - 6C		

NEW



BALL BEARING ASSISTED OPENING

15-UTKE40E

- Liner Lock
- D2 Steel Blade
- Blade Length 3"
- Closed Length 4"
- Pocket Clip

Pricing includes electro etch on blade.

12	25	50	100	200	500
68.12	66.13	64.36	62.59	60.82	59.05
Set up - \$86.25G)			Imprint Area - 1-1/2" x 1/2"		
Shipping Weight - 12 pcs @ 4 lbs			Class - 6C		

NEW



MADE IN USA with Globally Sourced Materials



EVERYDAY CARRY

BALL BEARING ASSISTED OPENING
15-UTKE45E

NEW

- Button Lock
- D2 Steel Blade
- Blade Length 3.25"
- Closed Length 4.5"
- Pocket Clip



Pricing includes electro etch on blade.

12	25	50	100	200	500
71.38	69.30	67.44	65.59	63.73	61.87
Set up - \$86.25G)			Imprint Area - 1-1/2" x 1/2"		
Shipping Weight - 12 pcs @ 5 lbs			Class - 6C		

BALL BEARING ASSISTED OPENING
15-UTKE46E

NEW

- Button Lock
- D2 Steel Blade
- Blade Length 3.25"
- Closed Length 4.5"
- Pocket Clip



Pricing includes electro etch on blade.

12	25	50	100	200	500
71.38	69.30	67.44	65.59	63.73	61.87
Set up - \$86.25G)			Imprint Area - 1-1/2" x 1/2"		
Shipping Weight - 12 pcs @ 5 lbs			Class - 6C		

BALL BEARING ASSISTED OPENING
15-9163L

- Liner Lock
- High Carbon Steel Blade
- Blade Length 3.5"
- Closed Length 4.75"
- Overall Length 8.25"
- Pocket Clip



Pricing includes laser engraving on blade.

12	25	50	100	200	500
49.80	47.70	45.08	44.55	43.77	43.24
Set up - \$70.00(G)			Imprint Area - 2" x 1/2"		
Shipping Weight - 12 pcs @ 6 lbs			Class - 6C		

MADE IN USA with Globally Sourced Materials

EVERYDAY CARRY



BALL BEARING ASSISTED OPENING

15-9134E

- Liner Lock
- 8Cr13MoV Steel Blade
- Blade Length 3.3"
- Closed Length 4.5"
- Overall Length 7.8"
- Pocket Clip

Pricing includes electro etch on blade.



12	25	50	100	200	500
33.99	32.56	30.77	30.41	29.87	29.52

Set up - \$86.25(G) Imprint Area - 1-1/2" x 3/8"
Shipping Weight - 12 pcs @ 5 lbs Class - 6C

4.5" WOOD HANDLE LINER LOCK

15-1045L

- Liner Lock
- High Carbon Steel Blade
- Blade Length 3.3"
- Closed Length 4.5"
- Overall Length 7.8"
- Pocket Clip

Pricing includes laser engraving on handle.



12	25	50	100	200	500
31.86	30.93	30.10	29.27	28.44	27.62

Set up - \$70.00(G) Imprint Area - 2" x 1/2"
Shipping Weight - 12 pcs @ 6 lbs Class - 6C

STAINLESS STEEL HANDLE



3" STAINLESS STEEL LOCKBACK

15-131029E

- High carbon stainless steel blade
- Blade length 2-1/4"
- Closed length 3"
- Overall length 5-1/4"

Price includes electro etch on handle

25	50	100	200	500	1000
30.50	29.61	28.82	28.02	27.23	26.44

Set Up - \$86.25(G) Imprint Area - 1-3/4" x 1/2"
Shipping Weight - 25 pcs @ 4-1/2 lbs Class - 6C

Who Buys?

Home & Garden, Recognition & Awards, Retailers, Military, Construction, Camping & Outdoors, Military, Automotive, Safety, Agriculture, Hunting Clubs, Unions

MADE IN USA with Globally Sourced Materials



FILET KNIVES

6" FILET KNIFE 15-701E

- Molded Polypropylene/Rubber Grip Handle
- 440C Steel Blade
- Blade Length 6"
- Overall Length 11.25"
- Nylon Sheath

Pricing includes electro etch on blade.

12	25	50	100	200	500
29.50	28.64	27.87	27.11	26.34	25.57
Set up - \$86.25(G)			Imprint Area - 2" x 1/4"		
Shipping Weight - 12 pcs @ 6 lbs			Class - 6C		

7.5" FILET KNIFE 15-702E

- Molded Polypropylene/Rubber Grip Handle
- 440C Steel Blade
- Blade Length 7.5"
- Overall Length 12.75"
- Nylon Sheath

Pricing includes electro etch on blade.

12	25	50	100	200	500
31.63	30.71	29.88	29.06	28.24	27.42
Set up - \$86.25(G)			Imprint Area - 2" x 3/8"		
Shipping Weight - 12 pcs @ 7 lbs			Class - 6C		

9" FILET KNIFE 15-703E

- Molded Polypropylene/Rubber Grip Handle
- 440C Steel Blade
- Blade Length 9"
- Overall Length 14.25"
- Nylon Sheath

Pricing includes electro etch on blade.

12	25	50	100	200	500
33.22	32.26	31.39	30.53	29.66	28.80
Set up - \$86.25(G)			Imprint Area - 2-1/2" x 3/8"		
Shipping Weight - 12 pcs @ 6 lbs			Class - 6C		

FILET KNIFE COMBO 15-785E

- Molded Polypropylene/Rubber Grip Handles
 - 440C Stainless Steel Blade
 - Blade Lengths 6", 7.5", 9"(15-701E, 15-702E & 15-703E)
 - Handle Length 5.25"
 - Nylon Rollup Sheath
- Pricing includes electro etch on blades.

12	25	50	100	200
137.22	133.23	129.66	126.09	122.52
Set up - \$86.25(G)			Imprint Area - 2-1/2" x 3/8"	
Shipping Weight - 12 pcs @ 16 lbs			Class - 5C	



Nylon Sheath included with Models 15-701E, 15-702E & 15-703E

MADE IN USA with Globally Sourced Materials

CLASSIC LOCKBACKS



CLASSIC LOCKBACKS

5" LOCKBACK 15-17101L

- High carbon steel blade
- Blade length 3-1/2"
- Closed length 5"
- Overall length 8-1/2"

Price includes laser engraved handle

25	50	100	200	500	1000
79.85	77.53	75.45	73.37	71.30	69.22

Set Up - \$70.00(G)

Shipping Weight - 25 pcs @ 19 lbs

Imprint Area - 2" x 5/16"
Class - 6C

5" LOCKBACK

15-17101E

- High carbon steel blade
- Blade length 3-1/2"
- Closed length 5"
- Overall length 8-1/2"

Price includes electro etch on blade

25	50	100	200	500	1000
78.89	76.59	74.54	72.49	70.44	68.39

Set Up - \$86.25(G)

Imprint Area - 1-3/4" x 1/2"

Shipping Weight - 25 pcs @ 19 lbs

Class - 6C



3" WOOD HANDLED LOCKBACK

15-169L

- High carbon steel blade
- Blade length 2-1/4"
- Closed length 3"
- Overall length 5-1/8"

Price includes laser engraved handle

25	50	100	200	500	1000
64.40	62.52	60.85	59.17	57.50	55.82

Set Up - \$70.00(G)

Shipping Weight - 25 pcs @ 3 lbs

Imprint Area - 1-1/4" x 3/8"
Class - 6C

15-169L

15-169E



3" WOOD HANDLED LOCKBACK

15-169E

- High carbon steel blade
 - Blade length 2-1/4"
 - Closed length 3"
- Overall length 5-1/8"

Price includes electro etch on blade

25	50	100	200	500	1000
63.40	61.55	59.91	58.26	56.61	54.96

Set Up - \$86.25(G)

Shipping weight - 25 pcs @ 3 lbs

Imprint Area - 1" x 3/8"

Class - 6C

Who Buys?

Home & Garden, Recognition & Awards, Retailers, Military, Construction, Camping & Outdoors, Military, Automotive, Safety, Agriculture, Hunting Clubs, Unions

MADE IN USA with Globally Sourced Materials



MULTI-TOOLS



TICK REMOVER TOOL

15-2100L

2.5" x 1.125" Blue Anodized Aluminum Tick Remover

Includes laser engraving on one side.

50	100	200	500	750	1000
8.57	8.32	8.09	7.87	7.65	7.42
Setup - \$70.00G)					Imprint Area - 1/2" x 1"
Shipping Weight - 50 pcs @ 2 lbs					Class - 6C

GRILL SCRAPER TOOL

15-2130E

5.375" x 2.56" Stainless Steel Grill Scraper
 Features-10 different grooves that will fit most grill grates, griddle scraper, bottle cap lifter, and hook hang hole

Includes electro etch in one location.

50	100	200	500	750	1000
7.59	7.37	7.17	6.98	6.78	6.58
Setup - \$86.25G)					Imprint Area - 2" x 5/8"
Shipping Weight - 50 pcs @ 5 lbs					Class - 6C

5 Notches for Round Grates from 1/32" to 1/2"

5 Notches for V-shaped Grates



Who Buys?
 Home & Garden,
 Employee Recognition
 & Awards, Retailers,
 Construction, Camping
 & Outdoors, Military,
 Automotive, Safety,
 Agriculture, Unions

MULTI-TOOLS



MULTI-TOOLS

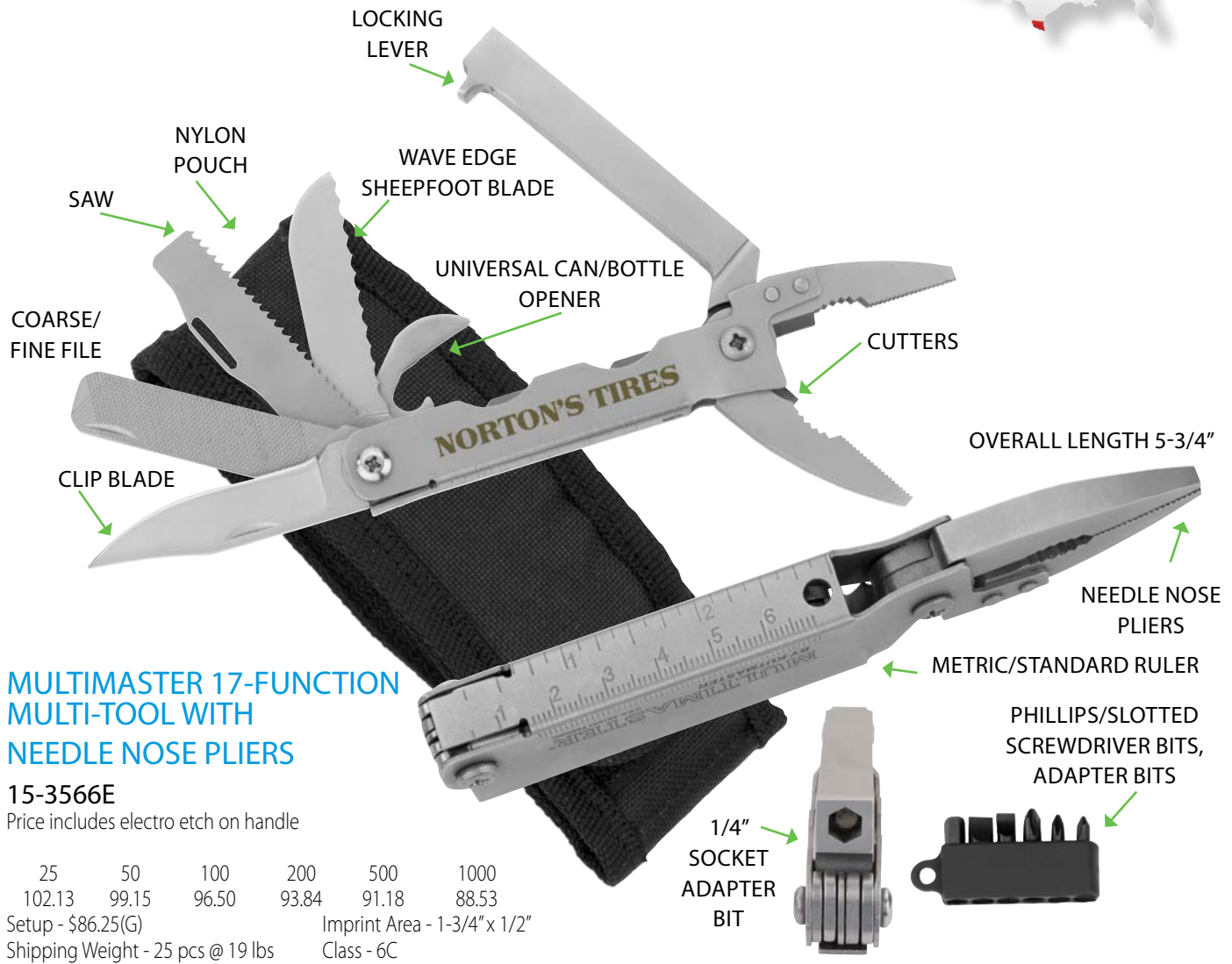

MULTIMASTER 17-FUNCTION MULTI-TOOL WITH NEEDLE NOSE PLIERS

15-3566E

Price includes electro etch on handle

25	50	100	200	500	1000
102.13	99.15	96.50	93.84	91.18	88.53
Setup - \$86.25(G)			Imprint Area - 1-3/4" x 1/2"		
Shipping Weight - 25 pcs @ 19 lbs			Class - 6C		

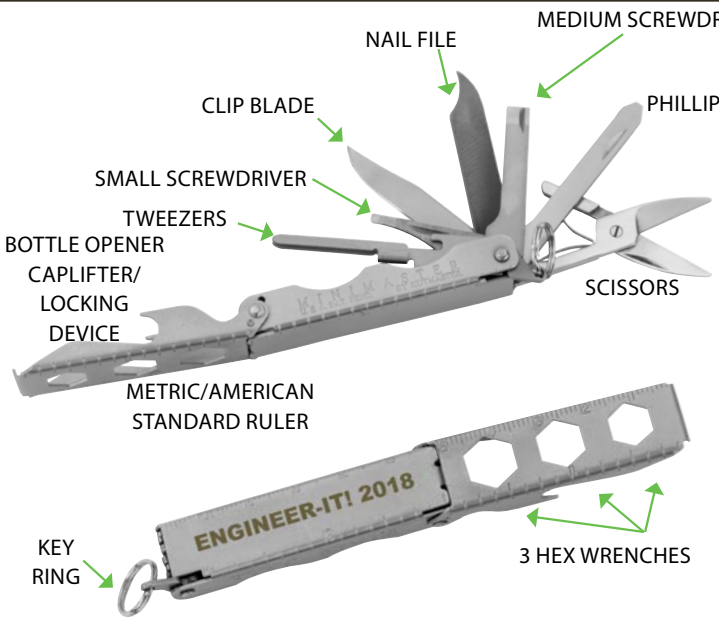

MINIMASTER 16-FUNCTION MULTI-TOOL

15-3536E
United States Patent 5,950,265
Price includes electro etch on handle.

25	50	100	200	500	1000
21.88	21.25	20.68	20.11	19.54	18.97
Setup - \$86.25(G)			Imprint Area - 1-3/4" x 5/16"		
Shipping Weight - 25 pcs @ 4-1/2 lbs			Class - 6C		

MADE IN USA with Globally Sourced Materials



COMMEMORATIVE KNIVES

OFFERED SINCE 1910, WITH THE SAME QUALITY AND FEATURES OF YESTERYEAR

HOW CUSTOM SCULPTURED METAL HANDLES ARE MADE

Utica uses a die casting method which is a metal casting process that is characterized by forcing molten metal under high pressure into a mold cavity. The mold cavity is created using two hardened tool steel dies which have been machined into shape and work similarly to an injection mold during the process.



SOLID BRASS HANDLE

CUSTOM FRONT

GENERIC INITIAL PANEL

3" CUSTOM BRASS LOCKBACK 15-131B

- Solid brass handle
- High carbon stainless steel blade
- Blade length 2-1/4"
- Closed length 3"
- Overall length 5-1/4"

250	500	700	1000	1500	2000
53.26	51.71	50.33	48.94	47.56	46.17
One time custom die charge - \$1,650.00 (G)					
Imprint Area - 3" x 3/4"					
Shipping Weight - 250 pcs @ 40 lbs					
Class - 6C					



CUSTOM DESIGN ON FRONT
GENERIC INITIAL PANEL ON BACK

NICKEL-SILVER HANDLES

3" CUSTOM NICKEL/SILVER LOCKBACK 15-131NS

- Nickel/Silver handle
- High carbon stainless steel blade
- Blade length 2-1/4"
- Closed length 3"
- Overall length 5-1/4"

PLEASE CONSULT FACTORY FOR PRICING.

Who Buys?
Employee Recognition & Awards, Retailers, Construction, Military, Automotive, Safety, Agriculture, Unions



CREATE YOUR OWN COMMEMORATIVE KNIVES

ANNIVERSARIES • MILESTONE'S • AWARDS

GREAT FOR UNIONS, CORPORATIONS, BRANDS



3" CUSTOM NICKEL-SILVER EQUAL END POCKET KNIFE

15-204NS

- High carbon stainless steel blades
- Blade lengths spear blade 2-1/2" pen blade 1-3/4"
- Closed length 3-3/8"
- Overall length 5-7/8"

PLEASE CONSULT FACTORY FOR PRICING.

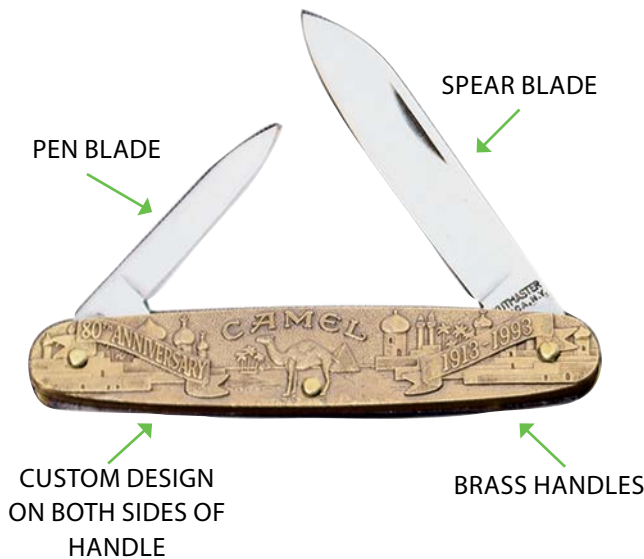

3" CUSTOM BRASS EQUAL END POCKET KNIFE

15-204B

- High carbon stainless steel blades
- Blade lengths - spear blade 2-1/2" / pen blade 1-3/4"
- Closed length 3-3/8"
- Overall length 5-7/8"

250	500	700	1000	1500	2000
53.26	51.71	50.33	48.94	47.56	46.17

One time custom die charge - \$1,650.00 (G)

Imprint Area - 3" x 3/4"

Shipping Weight - 250 pcs @ 45 lbs

Class - 6C





CUTLERY

NEW

CHEF KNIFE

15-746E

Chef knife includes a 7.5" black PVD coated blade and a Red G10 handle.

Pricing includes etching on blade.

12	25	50	100	200	500
91.41	88.75	86.37	84.00	81.62	79.24
Set up - \$86.25(G)			Imprint Area - 2" x 3/4"		
Shipping Weight - 12 pcs @ 7 lbs			Class - 6C		



NEW

CHEF KNIFE

15-747E

Chef knife includes a 7.5" black PVD coated blade and a Green G10 handle.

Pricing includes etching on blade.

12	25	50	100	200	500
91.41	88.75	86.37	84.00	81.62	79.24
Set up - \$86.25(G)			Imprint Area - 2" x 3/4"		
Shipping Weight - 12 pcs @ 7 lbs			Class - 6C		



MADE IN USA with Globally Sourced Materials



NEW



CLEAVER

15-750L

Cleaver includes a 7.5" black oxide coated blade and a wood handle. Includes leather sheath.

Pricing includes laser engraving on blade.

12	25	50	100	200	500
133.70	129.81	126.33	122.85	119.37	115.90
Set up - \$70.00(G)			Imprint Area - 2" x 3/4"		
Shipping Weight - 12 pcs @ 12 lbs			Class - 6C		

NEW



CHEF KNIFE

15-760L

Chef knife includes a 6.5" black oxide coated blade and a wood handle. Includes a leather sheath.

Pricing includes laser engraving on blade.

12	25	50	100	200	500
93.28	90.56	88.13	85.71	83.28	80.86
Set up - \$70.00(G)			Imprint Area - 2" x 3/4"		
Shipping Weight - 12 pcs @ 12 lbs			Class - 6C		

NEW



SANTOKU KNIFE

15-780L

Santoku includes a 8.5" black oxide coated blade and a wood handle. Includes a leather sheath.

Pricing includes laser engraving on blade.

12	25	50	100	200	500
93.28	90.56	88.13	85.71	83.28	80.86
Set up - \$70.00(G)			Imprint Area - 2" x 3/4"		
Shipping Weight - 12 pcs @ 12 lbs			Class - 6C		

MADE IN USA with Globally Sourced Materials

CUTLERY



12" LONG

7" SANTOKU KNIFE

95-45013E

Santoku style chef knife includes a 7" blade with a razor sharp edge and a full tang handle. Price includes one location electro etch on one side of blade.

25	50	100	200	500	1000
4.96	4.86	4.80	4.74	4.66	4.58
Set Up - \$86.25(G)				Imprint Area - 2-1/2" x 3/4"	
Shipping Weight - 25 pcs @ 8 lbs				Class - 6C	



8" LONG

8" UNIVERSAL SHEARS

95-45010E

8" Universal shears with stainless steel blades. Price includes one location electro etch on blade.

25	50	100	200	500	1000
5.53	5.42	5.35	5.28	5.19	5.10
Set Up - \$86.25(G)				Imprint Area - 1-3/4" x 1/4"	
Shipping Weight - 25 pcs @ 8 lbs				Class - 6C	



8" Chef's Knife

8" Slicing Knife

5" Utility Knife

3" Paring Knife

Universal Shears

6 pc PREP SET

95-45012L

6 piece prep cutlery set in wood storage block. Knives feature triple riveted handles with full tang blades. Price includes one location laser engraving on wood block.

25	50	100	200	500	1000
25.26	24.20	22.87	22.60	21.94	21.27
Set Up - \$70.00(G)				Imprint Area - 2" x 2"	
Shipping Weight - 25 sets @ 55 lbs				Class - 6C	

Who Buys?

Food & Beverage, Real Estate, Financial Institutions, Home & Garden, Camping & Outdoors, Retailers

Note: Variations in the darkness and depth of the laser marking may occur due to the variations in color and contrast of the wood.

BBQ TOOL

ON THE GO BBQ TOOL

95-UB264L

Barbeque tool includes Fork, Spatula, Tongs and Bottle Opener.
9" Closed, 11.5" Open.

Price includes one location laser on handle.

25	50	100	200	500	1000
27.53	26.73	26.01	25.29	24.58	23.86

Set Up - \$70.00(G)

Shipping Weight - 25 pcs @ 15 lbs

Imprint Area - 2" x 1/2"

Class - 6C



TONGS

NEW



CLOSED



FORK



SPATULA

CERAMIC CUTLERY



2.5" CERAMIC PARING KNIFE

95-740PP

Paring knife features a 2-1/2" razor sharp ceramic blade and a 4-1/4" ergonomic handle. Plastic sheath is included with knife. Price includes one color print on handle.

25	50	100	200	500	1000
6.20	6.08	6.00	5.92	5.82	5.72

Set up - \$50.00(G)

Shipping Weight- 25pcs @ 3 lbs

Imprint Area-1-3/4" x 1/2"

Class - 6C



4" CERAMIC UTILITY KNIFE

95-741PP

Utility knife features a 4" razor sharp ceramic blade and a 5" ergonomic handle. Plastic sheath is included with knife. Price includes one color print on handle.

25	50	100	200	500	1000
8.65	8.49	8.38	8.26	8.13	7.98

Set up - \$50.00(G)

Shipping Weight -25 pcs @ 5 lbs

Imprint Area- 2" x 1/2"

Class - 6C

Who Buys?

Food & Beverage, Real Estate, Financial Institutions, Home & Garden, Camping & Outdoors, Retailers

JUMBO STEAK KNIFE

JUMBO STEAK KNIFE

95-6405271E

Jumbo steak knife w/stainless blade, 2-rivet handle.
Price includes electro etch on blade.

25	50	100	200	500	1000
8.59	8.18	7.77	7.57	7.36	7.16
Set Up - \$86.25(G)			Imprint Area - 2-1/2" x 3/4"		
Shipping Weight - 50 pcs @ 16 lbs			Class - 6C		



10" LONG

ELECTRO ETCHED BLADE

JUMBO STEAK KNIFE

95-6405271L

Jumbo steak knife w/stainless blade, 2-rivet handle.
Price includes laser engraved handle.

25	50	100	200	500	1000
9.72	9.26	8.79	8.56	8.33	8.10
Set Up - \$70.00(G)			Imprint Area - 2-1/2" x 3/4"		
Shipping Weight - 50 pcs @ 16 lbs			Class - 6C		



10" LONG

LASER ENGRAVED HANDLE

JUMBO STEAK KNIFE IN BLOCK SET

95-WB6405276L

Wood steak knife block includes six lightwood handle jumbo steak knives. Price includes laser engraving on one side of block.

25	50	100	200	500	1000
44.10	42.00	39.90	38.85	37.80	36.75
Set Up - \$70.00(G)			Imprint Area - 2" x 2"		
Shipping Weight - 25 sets @ 65 lbs			Class - 6C		



ASSORTED SPECIALTY CUTLERY



BUTTER & CHEESE SPREADER

95-714NW

Butter/cheese spreader with white plastic handle. Price includes a one color pad print on handle. When ordering specify color wanted.

150	500	1000	2000	3000
4.30	4.19	4.07	3.96	3.84

Set Up - \$50.00(G)

Shipping Weight - 150 pcs @ 7 lbs

Imprint Area - 2-1/2" x 3/8"

Class - 5C



2-1/4" BLADE
6" LONG

WARNING:
Cancer and reproductive harm-
See www.P65Warnings.ca.gov
for more information.

PARING KNIFE

95-713NW

Paring knife with white plastic handle. Price includes a one color pad print on handle. When ordering specify color wanted.

150	500	1000	2000	3000
4.30	4.19	4.07	3.96	3.84

Set Up - \$50.00(G)

Shipping Weight - 150 pcs @ 6 lbs

Imprint Area - 2-1/2" x 3/8"

Class - 5C



2-1/2" BLADE
6-1/8" LONG

WARNING:
Cancer and reproductive harm-
See www.P65Warnings.ca.gov
for more information.

Who Buys?

Food & Beverage, Real Estate, Financial Institutions, Home & Garden, Camping & Outdoors, Retailers, Agriculture

OYSTER/CLAM KNIFE

95-718PP

Oyster knife/clam opener with white plastic handle. Price includes one color pad print on one side of handle.

100	200	500	1000	1500
7.28	7.08	6.89	6.69	6.50
Set Up - \$50.00(G)		Imprint Area - 2-1/2" x 1/2"		
Shipping Weight - 100 pcs @ 14 lbs		Class - 5C		

3" BLADE
7" LONG



BREAD KNIFE

95-715W

Bread knife with white plastic handle. Price includes a one color pad print on handle.

150	500	1000	2000	3000
5.15	5.08	5.02	4.93	4.85
Set Up - \$50.00(G)		Imprint Area - 2-1/2" x 5/8"		
Shipping Weight - 150 pcs @ 28 lbs		Class - 5C		

8-1/2" BLADE
13-1/2" LONG

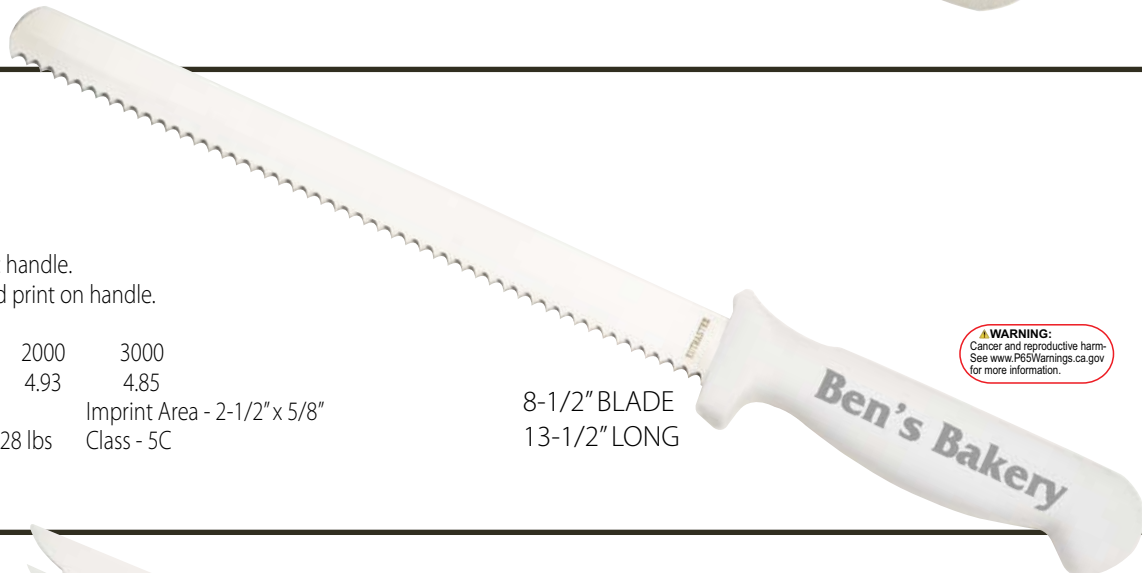

WARNING:
Cancer and reproductive harm.
See www.P65Warnings.ca.gov
for more information.

CARVE-N-SERVE KNIFE

95-716B

Carve-N-Serve knife with black plastic handle. Price includes a one color pad print on handle.

150	500	1000	2000	3000
3.67	3.63	3.58	3.52	3.46
Set Up - \$50.00(G)		Imprint Area - 2-1/2" x 5/8"		
Shipping Weight - 150 pcs @ 28 lbs		Class - 5C		

8-1/4" BLADE
13-1/8" LONG



WARNING:
Cancer and reproductive harm.
See www.P65Warnings.ca.gov
for more information.

ASSORTED SPECIALTY CUTLERY

FRUIT/VEGETABLE KNIFE

95-710NW

Fruit/vegetable also known as tomato knife. White plastic handle.
Price includes a one color pad print on handle.

150	500	1000	2000	3000
3.54	3.44	3.35	3.25	3.16

Set Up - \$50.00(G) Imprint Area - 2-1/2" x 3/8"
Shipping Weight - 150 pcs @ 7 lbs Class - 5C

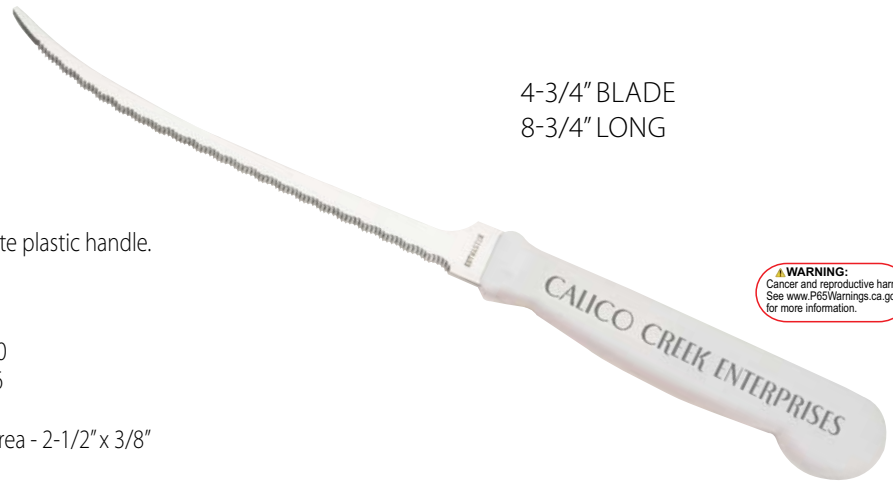

4-3/4" BLADE
8-3/4" LONG

WARNING:
Cancer and reproductive harm.
See www.P65Warnings.ca.gov
for more information.

PUMPKIN CARVER

95-712NO

Pumpkin carver with orange plastic handle.
Price includes a one color pad print on handle.

150	500	1000	2000	3000
4.26	4.15	4.03	3.92	3.80

Set Up - \$50.00(G) Imprint Area - 2-1/2" x 3/8"
Shipping Weight - 150 pcs @ 7 lbs Class - 5C



2-7/8" BLADE
6-1/2" LONG

WARNING:
Cancer and reproductive harm.
See www.P65Warnings.ca.gov
for more information.



SPECIALTY KITCHEN ACCESSORIES

PIZZA CUTTER

95-731WPP

8 1/4" Pizza cutter with white polypropylene handles and a stainless steel cutter. Price includes one color print on handle.



50	100	200	500	1000
4.12	4.04	3.98	3.87	3.76
Set Up - \$50.00 (G)				Imprint area: 2"x 1/2"
Shipping weight - 50 pcs @ 8 lbs				Class 5C

POTATO PEELER

95-732WPP

7" Potato peeler with white polypropylene handles and a stainless steel cutter. Price includes one color print on handle.



50	100	200	500	1000
4.09	4.01	3.96	3.84	3.73
Set Up - \$50.00 (G)				Imprint area: 2"x 1/2"
Shipping weight - 50 pcs @ 6 lbs				Class 5C

CARVING SET



12-3/4" LONG

11-1/4" LONG

11.25" SLICING KNIFE/CARVING FORK SET

95-45071E

Carving set features 8" blade slicing knife with carving fork.

Price includes one location electro etch on blade of knife.

25	50	100	200	500	1000
4.93	4.84	4.78	4.71	4.63	4.55
Set Up - \$86.25(G)				Imprint Area - 2-1/2" x 7/16"	
Shipping Weight - 25 sets @ 11 lbs				Class - 6C	

WINE ACCESSORIES



CORKSCREW

95-5002E

Stylish tube design corkscrew made of stainless steel with a beautiful satin finish. Features retractable boot lever, two set lever and an elongated spiral. Price includes electro etch on handle.

25	50	100	200	500	1000
7.67	7.52	7.43	7.33	7.21	7.08
Set Up - \$86.25(G)				Imprint Area - 2" x 1/4"	
Shipping Weight - 25 pcs @ 7 lbs				Class - 6C	

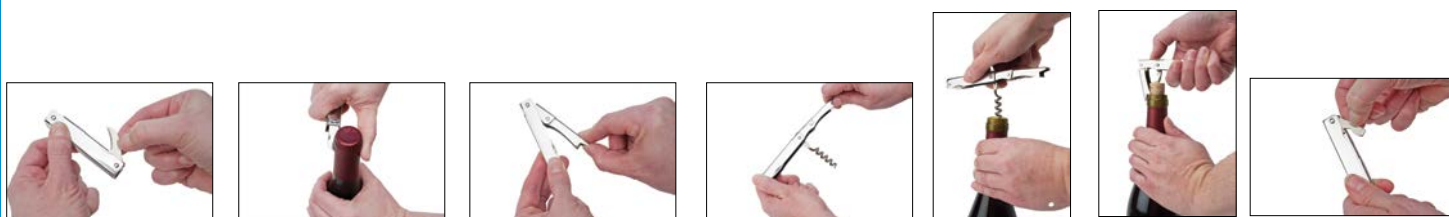

CORKSCREW

95-5003E

Stylish cube design corkscrew made of stainless steel with beautiful mirror finish. Features boot lever, spira and knife. Price includes electro etch on handles.

25	50	100	200	500	1000
7.47	7.32	7.23	7.13	7.01	6.89
Set Up - \$86.25(G)				Imprint Area - 2" x 1/2"	
Shipping Weight - 25 pcs @ 6 lbs				Class - 6C	



FOLD A SPORK

FROM THE KITCHEN TO THE CAMPSITE



FOLD A SPORK 95-UNI01PP

- Fork/Knife/Spoon
- Re-usable
- Durable
- Lightweight
- Portable/Compact

Price includes one color pad print on sleeve.

25	50	100	200	500	1000
4.61	4.39	4.17	4.06	3.95	3.84
Set up - \$50.00(G)			Imprint Area - 2" x 3/4"		
Shipping Weight - 25 pcs @ 2 lbs			Class - 6C		

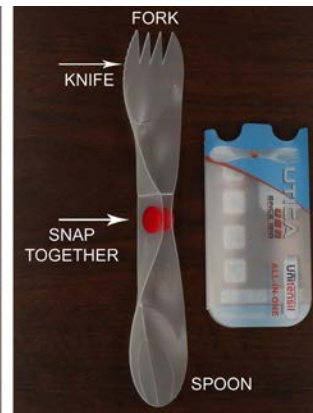

Who Buys?

Home & Garden, Retailers,
Construction, Camping
& Outdoors, Manufacturing,
Military, Automotive, Safety,
Agriculture



PRODUCE KNIVES



NEW

3 IN 1 AVOCADO TOOL

15-2150E

4-5/8" long, stainless steel Avocado tool includes: serrated edge for cutting, fork end for removing the pit and a scoop.
Price includes a one location electro etch.

25	50	100	200	500	1000
16.15	15.68	15.26	14.84	14.42	14.00
Set Up - \$70.00(G)			Imprint Area - 2" x 3/4"		
Shipping Weight - 25 pc @ 6 lbs			Class - 6C		



5-3/4" IVORY PLASTIC HANDLE FRUIT/VEGETABLE KNIFE

95-112WHS

4-7/8" long, 400 grade stainless blade with taper grind. Price includes one color pad print on handle. Total length open: 10-1/2".

25	50	100	200	500	1000
16.63	16.14	15.71	15.28	14.85	14.41
Set Up - \$50.00(G)			Imprint Area - 2 1/4" x 1/2"		
Shipping Weight - 25 pc @ 6 lbs			Class - 6C		



95-112WHS
PAD PRINT ON HANDLE



PRODUCE KNIVES



95-2712SS
PAD PRINT ON HANDLE

4-3/4" STAINLESS FRUIT/VEGETABLE KNIFE 95-2712SS

Features 3-7/8" Stainless Serrated pen blade with sampling fork.
Price includes one color pad print on handle.

25	50	100	200	500	1000
15.65	15.20	14.79	14.38	13.98	13.57
Set Up - \$50.00(G)			Imprint Area - 2-1/2" x 3/8"		
Shipping Weight - 50 pcs @ 16 lbs			Class - 6C		



95-2712E
ELECTRO ETCH ON HANDLE

4-3/4" STAINLESS FRUIT/VEGETABLE KNIFE 95-2712E

Features 3-7/8" Stainless serrated pen blade with sampling fork.
Price includes electro etch on handle.

25	50	100	200	500	1000
14.60	14.17	13.79	13.41	13.04	12.66
Set Up - \$86.25(G)			Imprint Area - 2-1/2" x 3/8"		
Shipping Weight - 50 pcs @ 16 lbs			Class - 6C		

Who Buys?

Bar & Restaurant, Food & Beverage, Agriculture

WARNING:
Cancer and reproductive harm.
See www.P65Warnings.ca.gov
for more information.



PRODUCE KNIVES



95-2714E
ELECTRO ETCH ON HANDLE

4-5/8" STAINLESS DOUBLE BLADED FRUIT/VEGETABLE SAMPLER w/NYLON POUCH

95-2714E

Blades are 3-3/4" long. One blade is serrated to cut through tough rinds and stalks, the other is taper ground with a razor sharp edge. Knife is stored in convenient belt loop pouch. Price includes electro etch on one handle.

	25	50	100	200	500	1000
	18.15	17.62	17.15	16.68	16.21	15.73
Set Up -	\$86.25(G)			Imprint Area - 2-1/2" x 3/8"		
Shipping Weight -	25 pcs @ 10 lbs			Class - 6C		



MODEL 95-2714SS
PAD PRINT ON HANDLE

4-5/8" STAINLESS DOUBLE BLADED FRUIT/VEGETABLE SAMPLER w/NYLON POUCH

Model 95-2714SS

Includes two 400 grade stainless spear blades. Blades are 3-3/4" long. One blade is serrated to cut through tough rinds and stalks, the other is taper ground with a razor sharp edge. Knife is stored in convenient belt loop pouch. Price includes one color pad print on handle.

	25	50	100	200	500	1000
	18.08	17.55	17.08	16.61	16.14	15.67
Set Up -	\$50.00(G)			Imprint Area - 2-1/2" x 3/8"		
Shipping Weight -	25 pcs @ 10 lbs			Class - 6C		

Who Buys?

Bar & Restaurant, Food & Beverage, Agriculture



PRODUCE KNIVES

4-7/8" STAINLESS FRUIT/VEGETABLE KNIFE

95-1712E

3-7/8" blade. Price includes electro etch on handle.

25	50	100	200	500	1000
14.25	13.84	13.47	13.10	12.73	12.35

Set Up - \$86.25(G)

Shipping Weight - 50 pcs @ 16 lbs

Imprint Area - 2-1/2" x 3/8"

Class - 6C

95-1712E
ELECTRO ETCH ON HANDLE



4-7/8" STAINLESS FRUIT/VEGETABLE KNIFE

95-1712SS

3-7/8" blade. Price includes one color pad print on handle.

25	50	100	200	500	1000
14.86	14.43	14.04	13.66	13.27	12.89

Set Up - \$50.00(G)

Shipping Weight - 25 pcs @ 8 lbs

Imprint Area - 2-1/2" x 3/8"

Class - 6C



95-1712SS
PAD PRINT ON HANDLE



RESCUE KNIFE

BALL BEARING ASSISTED OPENING

95-1839L

- Liner lock
- High carbon stainless steel blade
- Blade length 3"
- Closed length 4-1/4"
- Overall length 7-3/8"
- Smooth ball bearing opening
- Aluminum handle
- Belt Clip

Price includes laser engraving on handle.

25	50	100	200	500	1000
24.02	23.32	22.70	22.08	21.45	20.83
Set up - \$70.00(G)				Imprint Area - 1-1/2" x 1/4"	
Shipping Weight - 25 pcs @ 4 lbs				Class - 6C	





FOLDING SAW/GUTHOOK LOCKBACK

95-RT215L

- High carbon stainless steel blades
- Blade lengths – saw 3-1/2" / gut hook blade 3-1/2"
- Closed length 4-3/4"
- Overall length 8 1/8"

Price includes laser engraving on saw blade

25	50	100	200	500	1000
27.80	26.48	25.16	24.49	23.83	23.17
Set Up - \$70.00(G)				Imprint Area - 1-1/2" x 3/8"	
Shipping Weight - 25 pcs @ 9 lbs				Class - 6C	

WARNING:
Cancer and reproductive harm.
See www.P65Warnings.ca.gov
for more information.

SPECIALTY TOOLS

FROM THE GARAGE TO THE CAMPSITE



MULTIFUNCTION GARDEN SHEARS 95-5006PP

- High carbon stainless steel implements
- Plastic handles
- Closed length 4-5/8"
- Opened length 8"
- Nylon pouch

Price includes one color pad print on handle.

	25	50	100	200	500	1000	
	7.21	7.07	6.98	6.88	6.77	6.65	
Set Up -	\$50.00(G)					Imprint Area -	2-1/2" x 3/8"
Shipping Weight -	25 pcs @ 13 lbs					Class -	6C

WARNING:
Cancer and reproductive harm-
See www.P65Warnings.ca.gov
for more information.

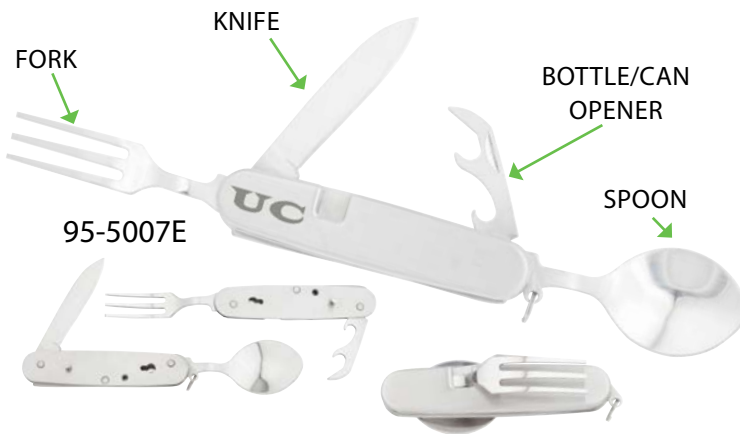

CAMPER'S TOOL 95-5007E

- High carbon stainless steel handle and implements
- Closed length 3 1/2"

Price includes electro etch in one location on handle.

	25	50	100	200	500	1000	
	4.78	4.69	4.63	4.56	4.49	4.41	
Set Up -	\$86.25(G)					Imprint Area -	3/4" x 1/2"
Shipping Weight -	100 pcs @ 28 lbs					Class -	6C

Who Buys?

Home & Garden, Retailers,
Construction, Camping
& Outdoors, Manufacturing,
Military, Automotive, Safety,
Agriculture

SPECIALTY TOOLS

KEY SHAPED FOLDING KNIFE

95-2005L

- Blade length 2-1/4"
- Closed length 2-3/4"
- Overall length 4-5/8"

Price includes laser engraving on key head.

25	50	100	200	500	1000
9.95	9.75	9.63	9.50	9.34	9.18
Set up - \$70.00(G)			Imprint Area - 1/2" x 3/4"		
Shipping Weight - 100 pcs @ 24 lbs			Class - 6C		



BOX OPENER DOGTAG STYLE KNIVES

- 95-6008RDL Red
- 95-6008BLL Blue
- 95-6008SL Silver
- 95-6008BKL Black

- Blade length 1-3/16"
- Closed length 2"
- Overall length 3-3/16"

Price includes laser engraving in one location.

25	50	100	200	500	1000
8.84	8.67	8.56	8.44	8.31	8.16
Set up - \$70.00(G)			Imprint Area - 3/4" x 1"		
Shipping Weight - 25 pcs @ 4 lbs			Class - 6C		



CLASSIC FOLDERS

3" LOCKBACK

95-1983E

- High carbon stainless steel blade
- Blade length 2-1/4"
- Closed length 3"
- Overall length 5-1/8"

Price includes electro etch on blade

25	50	100	200	500	1000
18.47	17.93	17.45	16.97	16.49	16.01

Set Up - \$86.25(G) Imprint Area - 1-1/4" x 3/8"
 Shipping Weight - 25 pcs @ 3 lbs Class - 6C

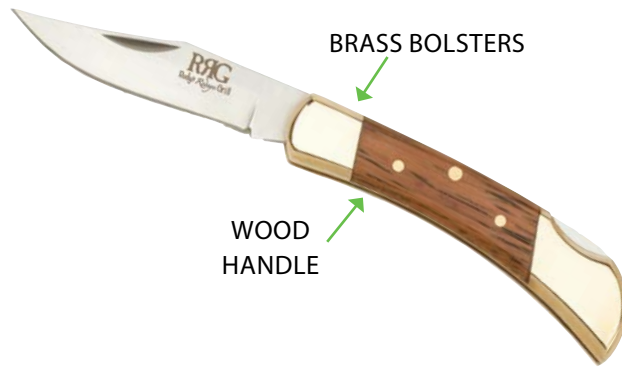

USA MADE AVAILABLE ON PAGE 7

3" LOCKBACK

95-1983L

- High carbon stainless steel blade
- Blade length 2-1/4"
- Closed length 3"
- Overall length 5-1/8"

Price includes laser engraved handle.

25	50	100	200	500	1000
19.57	19.00	18.49	17.98	17.47	16.96

Set Up - \$70.00(G) Imprint Area - 3/4" x 3/8"
 Shipping Weight - 25 pcs @ 3 lbs Class - 6C

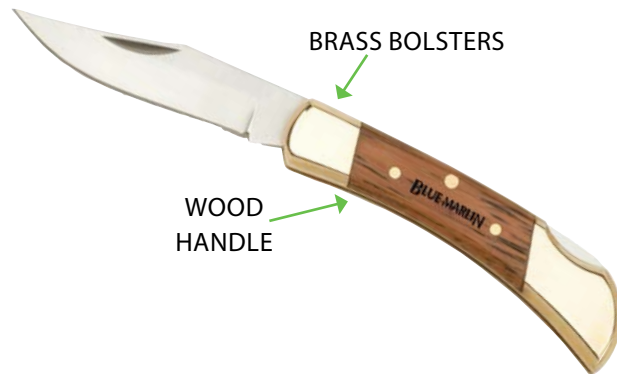

USA MADE AVAILABLE ON PAGE 7

MINI TOOLS

GREAT FOR POCKET, KEY CHAINS, BACKPACKS ...

CARABINER TOOL

95-5008L

- Aluminum handle
- High carbon stainless steel blades
- Closed length 2 5/8"

Price includes laser engraving on one side of handle.

25	50	100	200	500	1000
5.32	5.22	5.15	5.08	5.00	4.91
Set up - \$70.00(G)				Imprint Area - 1-1/4"x 3/8"	
Shipping Weight - 100 pcs @ 16 lbs				Class - 6C	



KEY CHAIN/POCKET TOOL

95-2006E

- 3-1/5" in length and 1/8" thick
- Nylon carrying case
- High carbon stainless steel

Price includes electro etch in one location.

25	50	100	200	500	1000
5.42	5.04	4.98	4.91	4.83	4.74
Set up - \$86.25(G)				Imprint Area - 1" x 1/4"	
Shipping Weight - 25 pcs @ 3 lbs				Class - 6C	

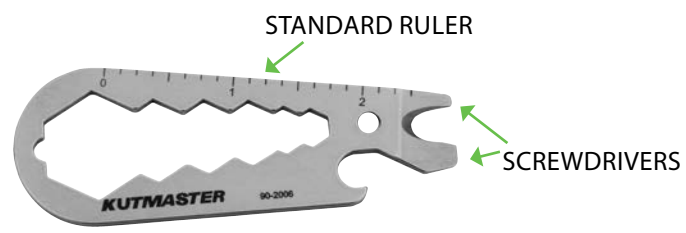
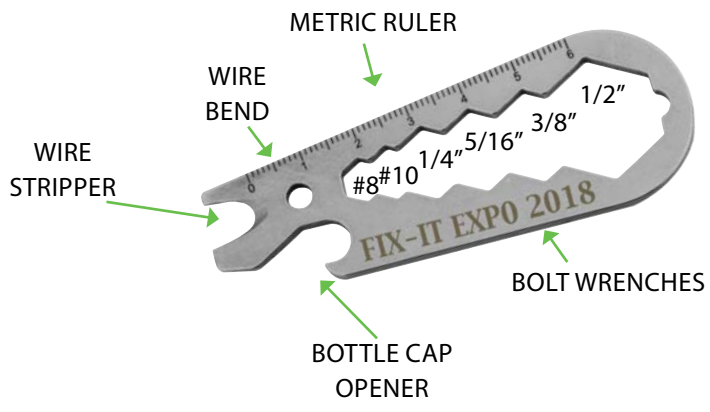

Who Buys?

Home & Garden, Employee Recognition & Awards, Retailers, Construction, Camping & Outdoors, Military, Automotive, Safety, Agriculture

EVERYDAY CARRY

STAINLESS STEEL LOCKBACK 95-181502E

- High carbon stainless steel blade
- Blade Length 2-1/4"
- Closed Length 2-7/8"
- Overall Length 5"

Price includes electro etch on handle

100	200	500	1000
7.09	6.97	6.70	6.51

Set Up - \$86.25(G) Imprint Area - 1-1/2" x 1/2"
Shipping Weight - 100 pcs @ 18 lbs Class - 4C

STAINLESS STEEL HANDLE



Who Buys?

Home & Garden, Retailers, Military, Construction, Camping & Outdoors, Military, Automotive, Safety, Agriculture, Hunting Clubs

3" LOCKBACK 95-1982L

- High carbon stainless steel blade
- Blade length 2-1/4"
- Closed length 3"
- Overall length 5"

Price includes laser engraved handle

100	200	500	1000
5.78	5.67	5.45	5.30

Set Up - \$70.00(G) Imprint Area - 2-1/4" x 1/2"
Shipping Weight - 100 pcs @ 18 lbs Class - 4C

TEAKWOOD HANDLE



Note: Variations in the darkness and depth of the laser marking may occur due to the variations in color and contrast of the wood.

EVERYDAY CARRY

BALL BEARING ASSISTED OPENING 95-RT903L

- High Carbon Stainless Steel Blade
- Blade Length 3"
- Closed Length 4"
- Overall Length 6-7/8"

Price includes laser engraving on handle

25	50	100	200	500	1000
19.66	19.09	18.58	18.06	17.55	17.04
Set Up - \$70.00(G)			Imprint Area - 1-1/2" x 1/4"		
Shipping Weight - 25 pcs @ 16 lbs			Class - 6C		



WOOD HANDLE LINER LOCK 95-1940L

- Liner Lock
- High Carbon Steel
- Blade Length 3.13"
- Closed Length 4.5"
- Overall Length 7.6"
- Pocket Clip

Price includes laser engraving on handle.

25	50	100	200	500	1000
18.13	17.60	17.13	16.66	16.19	15.71
Set up - \$70.00(G)			Imprint Area - 1-1/2" x 1/2"		
Shipping Weight - 25 pcs @ 10 lbs			Class - 6C		



OPEN ASSIST

TRIPLE ACTION SPRING ASSIST

95-RT200L

US PATENT #US08752298 Collins Bros. Design

- Liner lock
- High carbon stainless steel blade
- Blade length 3"
- Closed length 4-1/8"
- Overall length 7-1/4"

Price includes laser engraving on handle.

25	50	100	200	500	1000
25.99	25.22	24.55	23.87	23.19	22.52
Set Up- \$70.00(G)				Imprint area - 3/4" x 3/4"	
Shipping weight - 25 pcs @7 lbs				Class- 6C	



WARNING:
Cancer and reproductive harm-
See www.P65Warnings.ca.gov
for more information.

TRIPLE ACTION SPRING ASSISTED LINER LOCK

95-200PP

US PATENT #US08752298 Collins Bros. Design

- High carbon stainless steel blade
- Blade length 3"
- Closed length 4"
- Overall length 7-1/4"
- Pocket clip

Price includes one color pad print on handle.

25	50	100	200	500	1000
19.11	18.88	18.54	18.31	17.51	17.16
Set up - \$50.00(G)				Imprint Area - 1-1/8" x 1/2"	
Shipping Weight - 25 pcs @ 7 lbs				Class - 6C	



WARNING:
Cancer and reproductive harm-
See www.P65Warnings.ca.gov
for more information.

FILET KNIFE



FOLDING FILET KNIFE 95-7050E

- High carbon stainless steel blade
- Blade length 5.84"
- Closed length 7.34"
- Overall length 13.18"
- Rubberized handle
- Thumb stud

Price includes electro etch on blade.

12	25	50	100	200	500
22.83	22.16	21.57	20.97	20.38	19.79
Set up - \$86.25G)			Imprint Area - 2-1/2" x 3/8"		
Shipping Weight - 25 pcs @ 11 lbs			Class - 6C		

Who Buys?

Home & Garden, Retailers, Military,
Construction, Camping
& Outdoors, Military, Automotive,
Safety, Agriculture, Hunting Clubs

GENERAL INFORMATION • TERMS & CONDITIONS

Who buys knives . . .

The phrase we hear the most when doing trade shows is, I have no one to sell knives to. The question is, but do you? Knives are great for giveaways, corporate gifts and incentive programs. There are many markets that buy knives as they are a promotion that will last forever! We have a large variety of knives which includes pocket knives, multitools, and kitchen cutlery. The best thing about our company is that we specialize in cutlery. We have been in business for over 100 years and are still going strong. To give you some ideas we have listed several different markets that are currently purchasing knives along with what styles of knives they purchase.

Bar & Restaurant

Steak Knives, Cutlery , Fruit/Vegetable Knives, Wine Openers

Food & Beverage

Steak Knives, Fruit/Vegetable Knives, Cutlery , Wine Openers

Real Estate

Steak Knives, Cutlery

Home & Garden

USA Made Knives & Tools, Pocket Knives, Multitools, Cutlery

Employee Recognition & Awards

Pocket Knives, Cutlery, Steak Knives, USA Made Knives & Tools

Retailers

Steak Knives, Pocket Knives, Cutlery, Multitools

Military

Pocket Knives, Multitools, USA Made Knives & Tools

Construction

Pocket Knives, Multitools, USA Made Knives & Tools

Camping & Outdoors

Pocket Knives, Multitools, Cutlery, Fillet Knives, USA Made Knives & Tools

Manufacturing

Pocket Knives, Multitools, USA Made Knives & Tools

Automotive

Pocket Knives, Multitools

Safety

Pocket Knives, Multitools, USA Made Knives & Tools

Unions

USA Made Knives & Tools

IF YOU HAVE ANY QUESTIONS PLEASE FEEL FREE TO CONTACT US.

FOR LIMITED LIFETIME WARRANTY INFORMATION: www.uticausa.com

GENERAL INFORMATION – TERMS AND CONDITIONS

Camera Ready Art/Graphics:

Artwork that is not camera-ready such as photocopies, faxed art, business cards, unseparated art or art that needs to be laid out, touched up, or typeset etc, will be charged \$25.00(G).

Complex art is subject to art charges at a rate of \$50.00(G) per hour. This will be noted prior to acknowledgment of your order.

E-mailing Artwork:

Camera-ready art may be e-mailed in jpeg, tiff, or eps file format to artwork@uticacutlery.com

Proofs:

\$6.00(G) for fax or paper proofs will be added to all other charges. Revision of proofs will be recharged.

Note: Responsibility for design and imprint lies with buyer when a proof is approved or if no proof is requested.

Please note. Fax, paper or virtual proofs are only an indication of placement, size and representation of artwork on the product. Actual product color, logo color or electro etch shading will vary with the marking of the product.

Speculative/Preproduction Sample:

\$60.00(G) per time in addition to die, stencil, screen or laser set-up charge.

PRICING SUBJECT TO CHANGE

Over/Under Runs:

Due to the nature of our manufacturing process we reserve the right to under/overship any order by 5%

Less Than Minimum:

There is a charge of \$60.00 (G) for orders less than the quantity minimum.

Unimprinted Production:

Non imprint items will be billed at end quantity price. Minimum quantities apply. We will accept no returns.

Production Time:

Normal production time on most orders is 2 to 3 weeks. Rush orders are available and will be billed at \$60.00(G). Factory authorization is required.

Samples:

All imprinted samples billed at end quantity pricing, no returns will be accepted unless authorized by the factory.

Shipping:

- All orders are FOB our factory in Utica, NY
- Orders will be shipped the most convenient way unless otherwise specified
- For overnight or 2-day service, please furnish us with your carrier's account number

- Goods lost or damaged after leaving our facilities are the responsibility of the carrier
- For drop shipments or split shipments add \$15.00(G) per each additional address
- No C.O.D. shipment will be accepted

Returns:

All claims must be submitted in writing within ten days of receipt of goods. No merchandise will be accepted without prior authorization and a return number issued by the factory.

Trademark Usage:

Artwork, designs, logos, and trademarks imprinted on products in this catalog have been reproduced as an example of the quality of printing available from Utica Cutlery Company. They are not intended to represent or constitute an endorsement of Utica Cutlery Company or its products by any other company. Acceptance of copy or other material submitted by the customer for use by Utica Cutlery Company in producing the products ordered will be accepted by the factory as being submitted in full compliance with all applicable laws regarding trademark, service mark, copyright, right of privacy, patent contractual limitations or similar protection.

Utica Cutlery Company uses 3 marking methods to mark their products. Below is an explanation of each.

1. Electro Chemical Etch:

This process creates a dark brown/black image on the metal surface of the blades or handles of our product. The image is transferred through a stencil with electrolyte solution and an electrical charge. The final product is a dark brown/black mark which is burned into the surface layer of the metal.

2. Laser Engraving:

This process entails the use of a gas mixture, CO2 laser which creates a cutting beam, that will engrave into our wood, plastic, Poly-Pro or metal surfaces. The final finish color or shading varies and is largely based on the make-up and consistency of the wood, plastic and anodized surface.

3. Pad Printing:

This process uses a flexible silicon rubber transfer pad that picks up a film of the ink from a photo-etched printing plate and transfers it to a 3 dimensional part surface. We can transfer up to 4 colors to our wood, plastic or metal products.

Exact Repeat Set up Charges:

Electro Etch \$0.00
Laser \$43.75(G)
Pad Print \$43.75(G)

Second Location Charges:

Laser Engraving \$70.00(G), Run Charge \$1.64(G) per knife/tool
Pad Printing \$50.00(G), Run Charge \$1.06(G) per knife/tool
Electro Etch \$86.25(G) Run Charge \$1.25(G) per knife/tool
Personalization \$3.00(G) per name

Pad Printing

2 color set up \$100.00(G), Run Charge \$1.06(G) per knife/tool
3 color set up \$150.00(G), Run Charge \$2.12(G) per knife/tool
4 color set up \$200.00(G), Run Charge \$3.18(G) per knife/tool

Standard Pad Print Colors:

White	Red 032 C	Black
Forest Green 355	Gold (Metallic)	Green 347
Reflex Blue	Yellow C	Orange 021 C

Web Site:
uticaccpromo.com

ASI/93130 • PPAI 113227 • UPIC KUT1910 • SAGE 54118

UTICA
CUTLERY CO[®]

KUTMASTER 400 LINE